

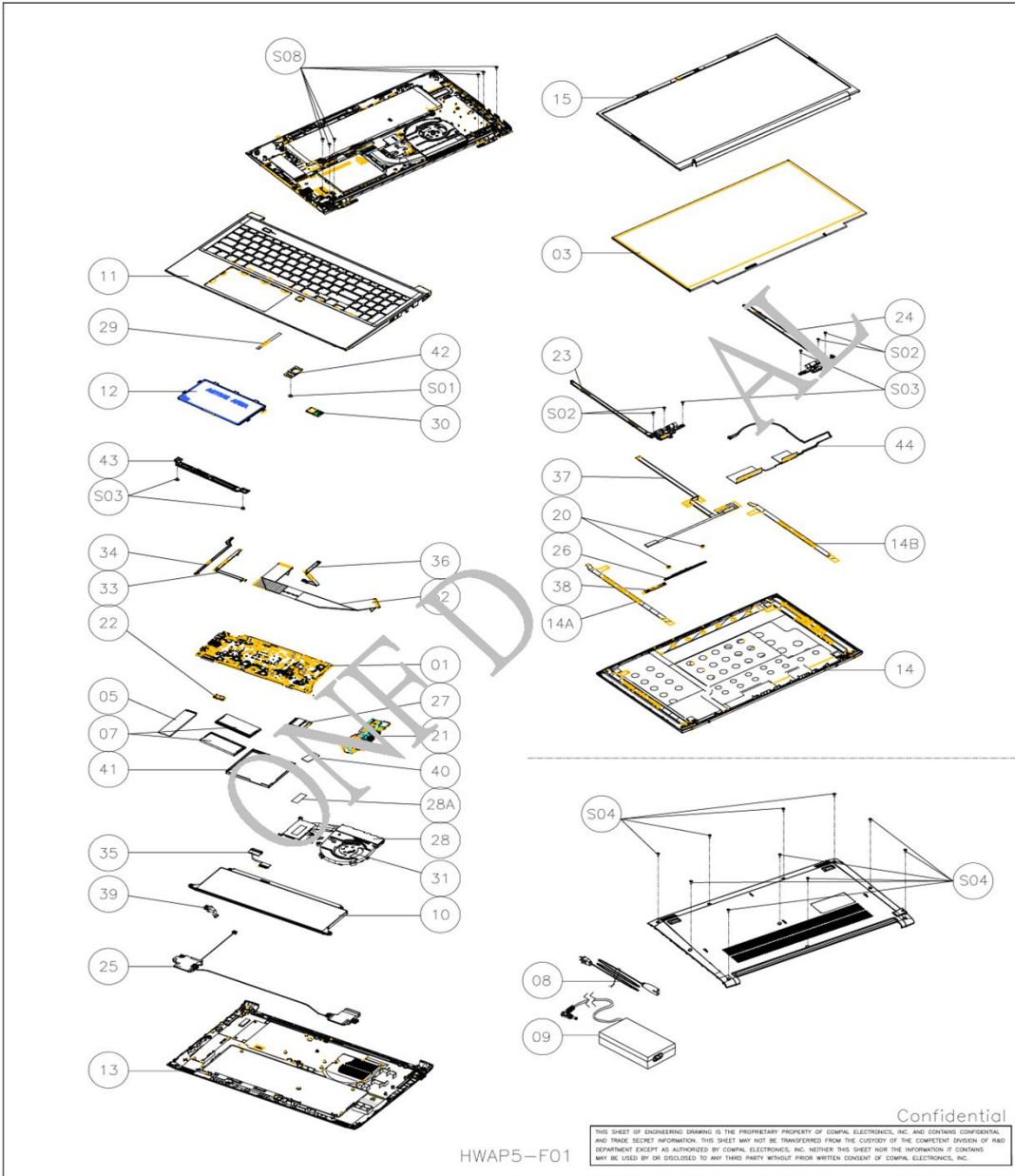

PARTS LIST

| | |
|----------------|----------------|
| Model Name: | C50-K |
| SKUNo [Short]: | PSY19E, PSY1AE |

| SeqNo | LocNo | ToshibaPN | ODMCODE | Category | Description | VendorPN |
|-------|-------|------------|--------------|----------|---------------------------|------------------------|
| 1 | 01-AV | K000907890 | | PCB | MOTHER BOARD ASSY | |
| 2 | 03-A | P000823120 | G33C000AM110 | LCD | LCD 15.6 FHD 250 | LQ156M1JW01 |
| 3 | 05-A | P000835340 | G8BC000CT250 | SSD | SSD M.2 256GB | MZVLQ256HBJD-00B00 |
| 4 | 05-A | P000846760 | G8BC000CX250 | SSD | SSD M.2 256GB | C-E80T256G2-P003D2E19T |
| 5 | 07-A | P000845410 | G4BC0003N8S0 | MEM | MEMORY DDR4 3200 8GB | M471A1G44BB0-CWE |
| 6 | 07-A | P000848490 | G4BC0003F8M3 | MEM | MEMORY DDR4 3200 8GB | MTA4ATF1G64HZ-3G2F1 |
| 7 | 07-A | P000824230 | G4BC0003F8M1 | MEM | MEMORY DDR4 3200 8GB | MTA4ATF1G64HZ-3G2E2 |
| 8 | 07-A | P000824220 | G4BC0003E8S0 | MEM | MEMORY DDR4 3200 8GB | M471A1G44AB0-CWE |
| 9 | 08-B | P000537110 | GDM900001221 | ACC | AC CORD SET(3WIRE) | 063013/8 |
| 10 | 08-B | P000554120 | GDM900002250 | ACC | AC CODE SET 3PIN | 102927/8 |
| 11 | 09 | P000850630 | G71C000MPL30 | ADP | AC ADAPTOR-L 3P 45W 2.37A | PA-1450-60T1_PIN3.5 |
| 12 | 09 | P000850650 | G71C000MPC30 | ADP | AC ADAPTOR-L 3P 45W 2.37A | A045R096P-DA01-X1 |
| 13 | 11-DD | K000904960 | | KB | KB ASSY BLUE FRE | |
| 14 | 12 | K000898030 | | TP | TOUCH PAD | |
| 15 | 13 | K000897910 | | COV | BASE ASSY | |
| 16 | 14 | K000898450 | | COV | LCD COVER | |
| 17 | 14A | K000898540 | | CUS | LCD PULL TAPE L | |
| 18 | 15-A | K000898420 | | COV | LCD BEZEL | |
| 19 | 20 | K000897250 | | CUS | MIC RUBBER | |
| 20 | 22 | K000896740 | | PCB | LID BOARD | |
| 21 | 23 | K000898500 | | BH | LCD HINGE L | |
| 22 | 24 | K000898510 | | BH | LCD HINGE R | |
| 23 | 25 | K000897960 | | SPK | SPEAKER L/R | |
| 24 | 26-A | K000897240 | | COM | CAMERA | |
| 25 | 27-B | P000816110 | G86C0007TD10 | COM | WLAN+BT COMBO MODULE | AX201.NGWW.NVW |
| 26 | 28 | K000897480 | | ETC | THERMAL MODULE | |
| 27 | 29 | K000896800 | | ETC | TP CONDUCTIVE TAPE | |
| 28 | 31 | K000897500 | | FAN | FAN | |
| 29 | 32 | K000897970 | | HAR | FFC IO BOARD TO MB | |
| 30 | 33 | K000898050 | | HAR | FFC TP TO MB | |
| 31 | 34 | K000897980 | | HAR | FFC LID BOARD TO MB | |
| 32 | 35 | K000897950 | | HAR | BATTERY CABLE | |
| 33 | 37-A | K000898530 | | HAR | EDP CABLE | |
| 34 | 38-A | K000897220 | | HAR | FPC CAMERA | |
| 35 | 39 | K000896860 | | HAR | DC IN HARNESS | |
| 36 | 40 | K000896870 | | INS | WLAN MYLAR | |
| 37 | 41 | K000896880 | | PLT | DDR SHIELDING | |
| 38 | 43 | K000898020 | | PLT | TP SUPPORT BRACKET | |
| 39 | 44 | K000898490 | | ANT | ANTENNA WLAN MAIN/AUX SET | |
| 40 | S02 | K000897900 | | SCR | SCREW M2X2.5 | |
| 41 | S03 | K000897300 | | SCR | SCREW M2.0X3.0 | |
| 42 | S04 | K000897310 | | SCR | SCREW M2X5 | |
| 43 | S08 | K000897340 | | SCR | SCREW M2.5X5.0 | |



HWP5-F01

Confidential

THIS SHEET OF ENGINEERING DRAWING IS THE PROPRIETARY PROPERTY OF COMPAQ ELECTRONICS, INC. AND CONTAINS CONFIDENTIAL AND TRADE SECRET INFORMATION. THIS SHEET MAY NOT BE TRANSMITTED FROM THE CUSTODY OF THE COMPETENT DIVISION OF R&D DEPARTMENT EXCEPT AS AUTHORIZED BY COMPAQ ELECTRONICS, INC. NEITHER THIS SHEET NOR THE INFORMATION IT CONTAINS MAY BE USED BY OR DISCLOSED TO ANY THIRD PARTY WITHOUT PRIOR WRITTEN CONSENT OF COMPAQ ELECTRONICS, INC.